

PERMIT # _____



City of Aurora, Ohio - Planning, Zoning and Building Division
129 W. Pioneer Trail, Aurora, OH 44202 330.562.9564 Fax: 330.562.9719 www.auroraoh.com

PAVING PERMIT APPLICATION

PLEASE PRINT:

Project Address: _____

Owner's Name: _____

Owner's Address (if different than above): _____

City _____ State _____ Zip Code _____ Phone _____

Contractor Name:** _____

Address: _____ City _____ State _____ Zip Code _____

Phone _____ Cell _____

**** All Contractors Must Be Registered With The Planning, Zoning & Building Division.**

PROJECT INFORMATION (check all that apply):

All Paving Projects Must Be Approved and Signed-Off by the Aurora Service Department.

CONCRETE:

- DRIVEWAY _____
- DRIVEWAY EXTENSION _____
- APRON _____
- SIDEWALK _____
- PAD/PATIO _____
- OTHER _____

ASPHALT:

- DRIVEWAY _____
- DRIVEWAY EXTENSION _____
- APRON _____
- OTHER _____

TOTAL SQUARE FOOTAGE: _____

SERVICE DEPARTMENT SIGN-OFF

APPROVAL: _____

DATE: _____

Acceptance of the permit herein applied for shall constitute an agreement on my/our part to abide by all conditions herein contained and to comply with all ordinances of the City of Aurora and the laws of the State of Ohio relating to all work to be done thereunder; and said agreement is a condition of said permit.

Applicant Signature _____

Sign & Print Name

Owner/Agent

SITE PLAN

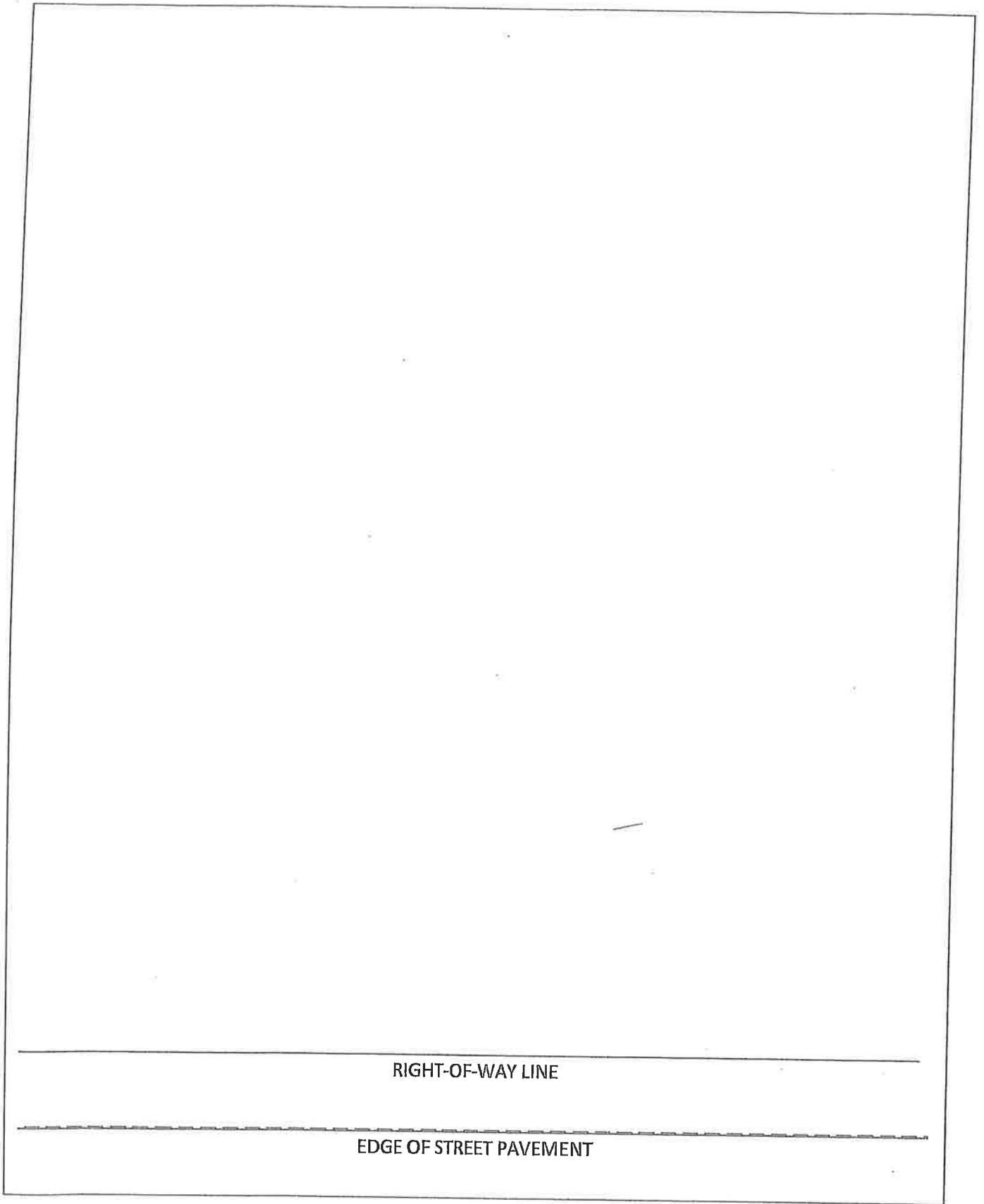

RIGHT-OF-WAY LINE

EDGE OF STREET PAVEMENT

CENTER LINE OF STREET

City of Aurora - Application for Work in City Right of Way

158 W. Pioneer Trail, Aurora, OH 44202 - 330-995-6116

Permit Number _____

Date of Application _____

Undersigned hereby requests permission to excavate in a street or public way for the purpose of:

Location and Description of work (Address, lot number, legal description):

This work will begin on _____ and will be completed within _____ days thereafter.
Excavation Length (ft): _____ Width (ft): _____

General Conditions

A copy of the Right-of-Way/Easement Permit must be kept on site at all times, including all plans and Maintenance of Traffic plan (MOT).

This permit is issued for work in right-of-way ONLY. Contractor is responsible for any other permits/reviews as required. Applicant shall comply with all the conditions, restrictions, and regulations of state and federal agencies, and the City of Aurora.

After completion of work, restoration shall be completed within 48 hours.

Contractors and subcontractors must be registered with the Planning, Zoning & Building Department. Applicant shall submit a security bond in the sum of Ten Thousand (\$10,000) Dollars to secure and hold harmless the City of Aurora as set forth in Chapter 1327.04.

It is the contractor's responsibility to call OUPS (1.800.362.2764) before any excavation. All utility crossings for underground installation shall be investigated per OUPS requirements and Ohio Damage Prevention Law.

Any damage during construction must be repaired immediately following City of Aurora Engineering and Construction Standards. Failure to do so may result in forfeiture of the contractor bonds and registration. The City of Aurora also reserves the right to seek other remedies as necessary.

Engineered plans and MOT are required for all above ground and/or underground linear utility installations including gas, electric, and/or communications utilities. Engineered plans are not required for culverts, driveways, and perpendicular utilities services unless otherwise specified by the Director of Public Services. Other types of work, including but not limited to soil boring and pavement cores, may require engineered plans as specified by the Director of Public Services.

Engineered plans and MOT must be signed, dated, and sealed by a Professional Engineer registered in the State of Ohio per Ohio Revised Code 4733.

Applicant shall adhere to all requirements of the Ohio Manual of Uniform Traffic Control Devices (OMUTCD).

Open cutting of roadways is strictly prohibited. For any driveway work, applicant must also complete a paving permit with the Planning Department.

Minimum separation from outside diameter of water main, force main, and sanitary sewer is five feet (5').

The City of Aurora Water Department will not mark utilities until a Right-of-Way Permit has been issued.

The contractor(s) and permittee(s) agree to hold the City of Aurora harmless from and against all claims, demands, actions, damages, or loss in connection with this work.

Road Closure Restriction - No disruption or work zone setup shall take place between the hours of 7-9 AM and 4-6 PM at the following locations:

SR 82: Bissell to SR 306

SR 43: SR 82 to Aurora-Hudson

SR 306: SR 82 to SR 43

I have reviewed and agree to all conditions as set forth in this permit application:

Applicant Name

Signature

Address

Phone Number

Email Address

Office Use Only:

Inspection required, please contact the Dept. of Public Services at 330.995.9116, 48 hour notice required

Inspection required, please contact the Dept. of Public Services at 330.995.9116, of restored property address after restoration is complete

Inspection not required

Pre-construction video required

City Official Name

City Official Signature

Date

City Comments:



This permit is valid for 90 days from the date of city authorization

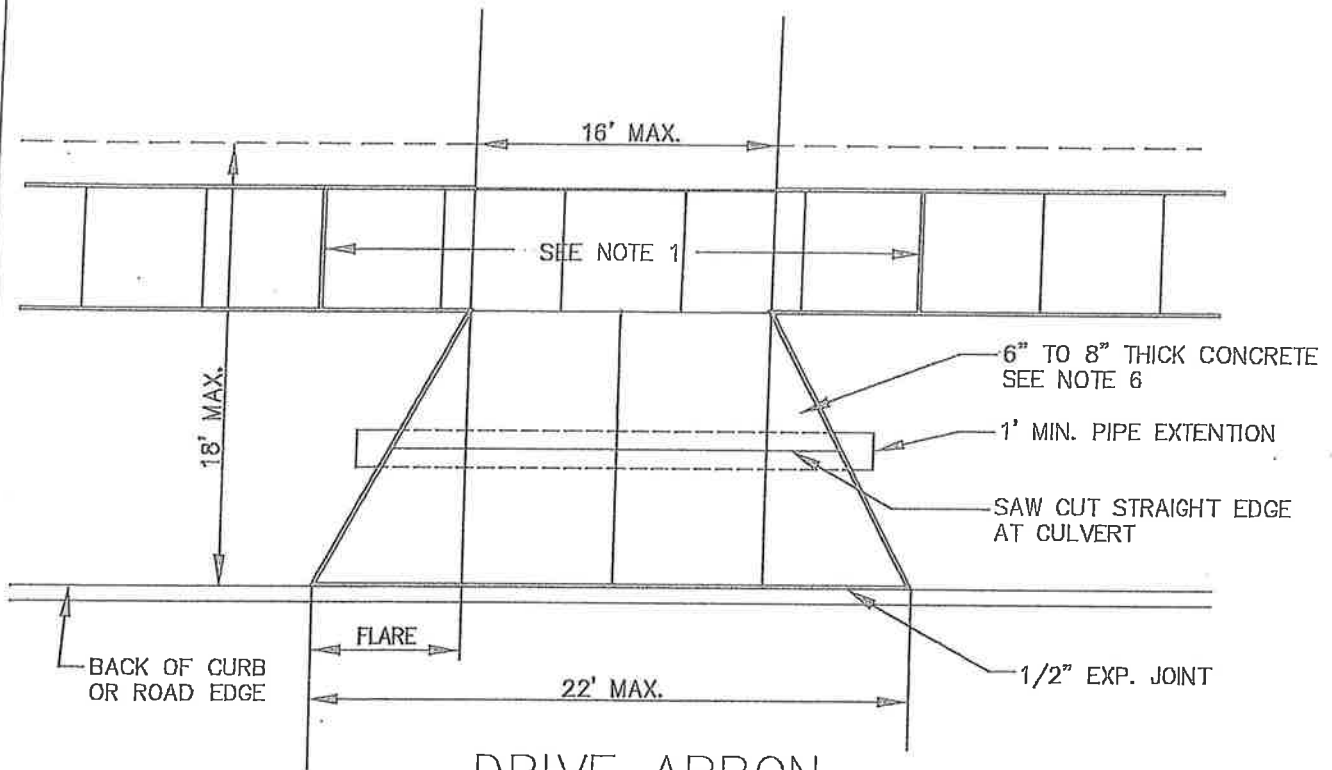

DRIVE APRON (PRIVATE, NON-DEDICATED ROADS)

NOT TO SCALE

NOTES:

1. SEE SIDEWALK DETAIL FOR WIDTH, MINIMUM THICKNESS, AND GRANULAR MATERIAL REQUIREMENTS. THE WALK THAT CROSSES THE DRIVE INCLUDING 5' OUT ON EACH SIDE SHALL BE 6" THICK FOR RESIDENTIAL AND 8" THICK FOR COMMERCIAL DRIVEWAYS. LENGTH MAY VARY PER FIELD CONDITION AS DETERMINED BY CITY.
2. DURING NEW CONSTRUCTION CURB CUTS SHALL BE DONE IN TWO PHASES WITH POWER SAW TO MAKE HORIZONTAL CUT. NO VERTICAL CUTS WITH CHISEL OR HAMMER IS PERMITTED. 1ST PHASE CUT PRIOR TO CONSTRUCTION AT 2 1/2" DEPTH. 2ND PHASE CUT JUST PRIOR TO INSTALLATION OF THE DRIVE APRON LEAVING A 1" LIP. FINAL SAW CUT SHALL END WITH A 6" TAPER.
3. FULL DEPTH SAW CUT IS REQUIRED AT EXISTING ASPHALT EDGE.
4. ALL EXPANSION JOINT MATERIAL SHALL BE RUBBERIZED EXPANSION AND SHALL BE TRIMMED 1/8" FINISHED GRADE.
5. FOR UNCURBED ROADS, CONCRETE DRIVEWAY SHALL BE SET BACK 12" TO 18" FROM THE EDGE OF THE ROAD.
6. RESIDENTIAL DRIVE SHALL BE 6" THICK CONCRETE (ODOT CLASS QC1, FIBER REINFORCED). COMMERCIAL DRIVES SHALL BE 8" THICK CONCRETE (ODOT CLASS QC1, FIBER REINFORCED).

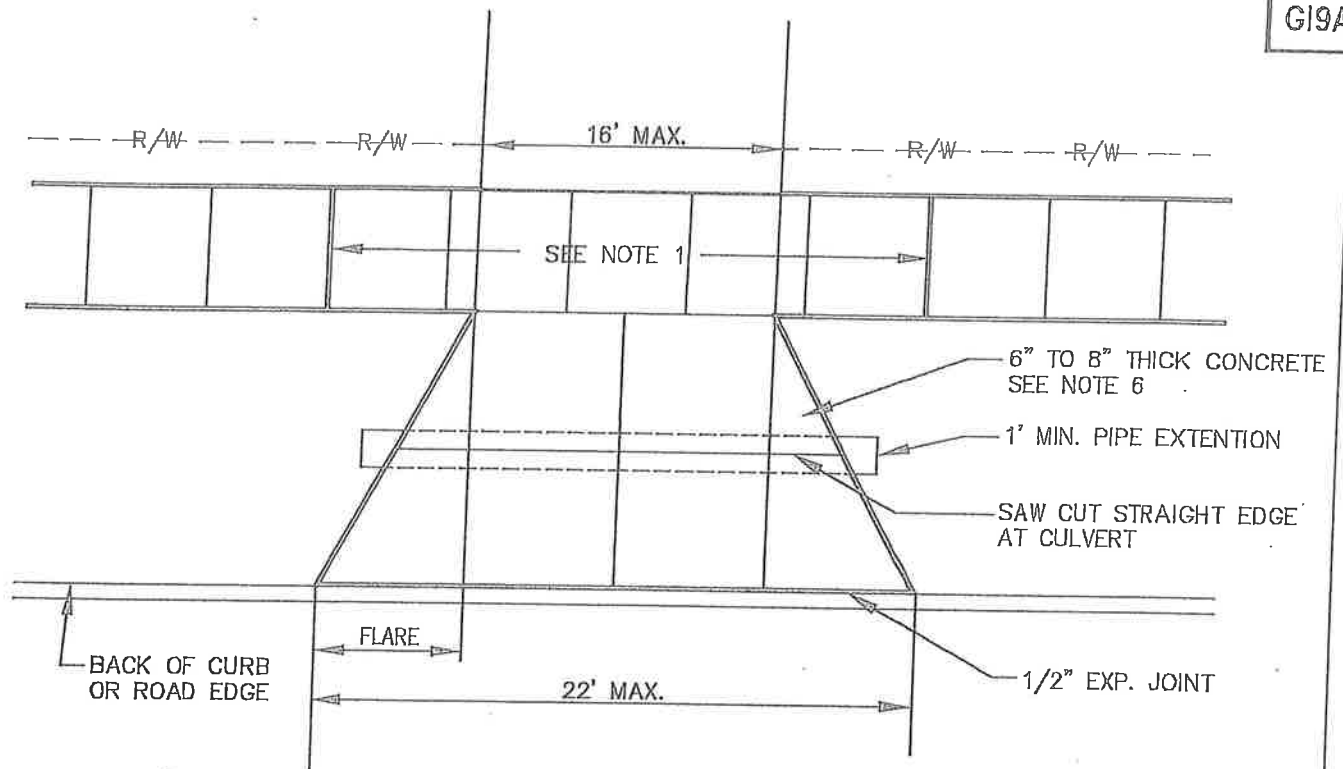

DRIVE APRON (DEDICATED ROADS)

NOT TO SCALE

NOTES:

- SEE SIDEWALK DETAIL FOR WIDTH, MINIMUM THICKNESS, AND GRANULAR MATERIAL REQUIREMENTS. THE WALK THAT CROSSES THE DRIVE INCLUDING 5' OUT ON EACH SIDE SHALL BE 6" THICK FOR RESIDENTIAL AND 8" THICK FOR COMMERCIAL DRIVEWAYS. LENGTH MAY VARY PER FIELD CONDITION AS DETERMINED BY CITY.
- DURING NEW CONSTRUCTION CURB CUTS SHALL BE DONE IN TWO PHASES WITH POWER SAW TO MAKE HORIZONTAL CUT. NO VERTICAL CUTS WITH CHISEL OR HAMMER IS PERMITTED. 1ST PHASE CUT PRIOR TO CONSTRUCTION AT 2 1/2" DEPTH. 2ND PHASE CUT JUST PRIOR TO INSTALLATION OF THE DRIVE APRON LEAVING A 1" LIP. FINAL SAW CUT SHALL END WITH A 6" TAPER.
- FULL DEPTH SAW CUT IS REQUIRED AT EXISTING ASPHALT EDGE.
- ALL EXPANSION JOINT MATERIAL SHALL BE RUBBERIZED EXPANSION AND SHALL BE TRIMMED 1/8" FINISHED GRADE.
- FOR UNCURBED ROADS, CONCRETE DRIVEWAY SHALL BE SET BACK 12" TO 18" FROM THE EDGE OF THE ROAD.
- RESIDENTIAL DRIVE SHALL BE 6" THICK CONCRETE (ODOT CLASS QC1, FIBER REINFORCED). COMMERCIAL DRIVES SHALL BE 8" THICK CONCRETE (ODOT CLASS QC1, FIBER REINFORCED).

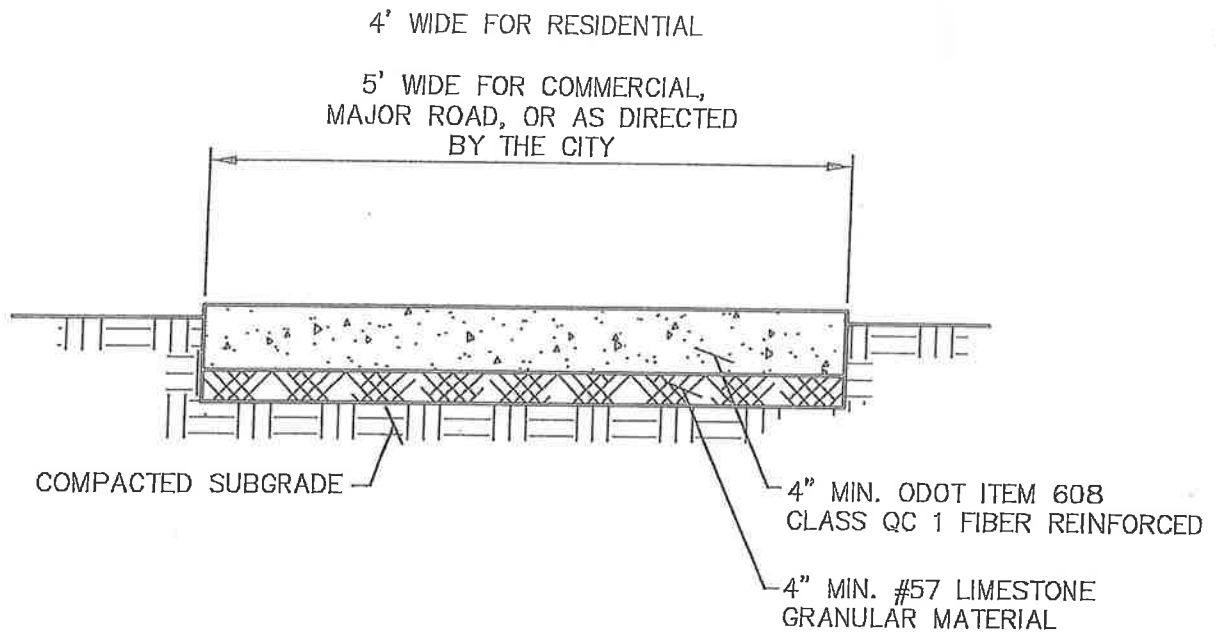

CONCRETE WALKS

NOTES:

1. CROSS SLOPES FOR WALKS = $3/16$ " PER FOOT.
2. PROVIDE TOOL IMPRESSED JOINTS $1/4$ " WIDE MINIMUM 1" DEEP AT 5' INTERVALS. EXPANSION CONTROL JOINT SHALL BE PROVIDED EVERY 100' INTERVALS UNLESS OTHERWISE NOTED ON THE PLANS. USE ONLY $1/2$ " JOINT MATERIALS FULL DEPTH. RUBBERIZED EXPANSION SHALL BE FLUSH WITH CONCRETE EDGES.
3. BROOM FINISH PERPENDICULAR TO TRAFFIC FLOW. TROWEL FINISH EDGES. APPLY CURING AND SEALING COMPOUNDS PER ODOT 451.11.
4. ALL SIDEWALKS SHALL HAVE FOLLOWING THICKNESS:
 - 4" TYPICAL THICKNESS
 - 6" RESIDENTIAL DRIVE APRONS (5' ON EACH SIDE OF DRIVE)
 - 8" COMMERCIAL DRIVE APRONS (5' ON EACH SIDE OF DRIVE)